

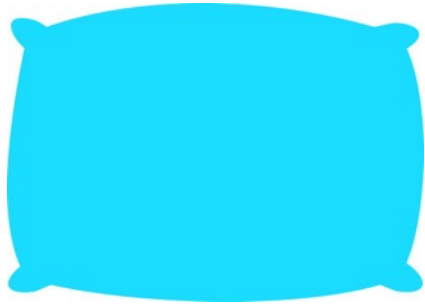

STACK

How to make spaces responsive

Why have connected devices?



Improve UX

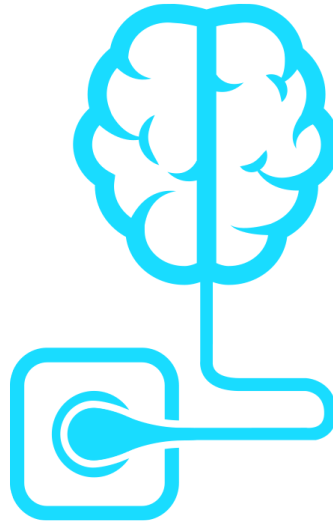

Simplify Setup



Automated
and Efficient

The current problems with building controls systems



Complex



Expensive



Installation

Slowly improving is not the answer...

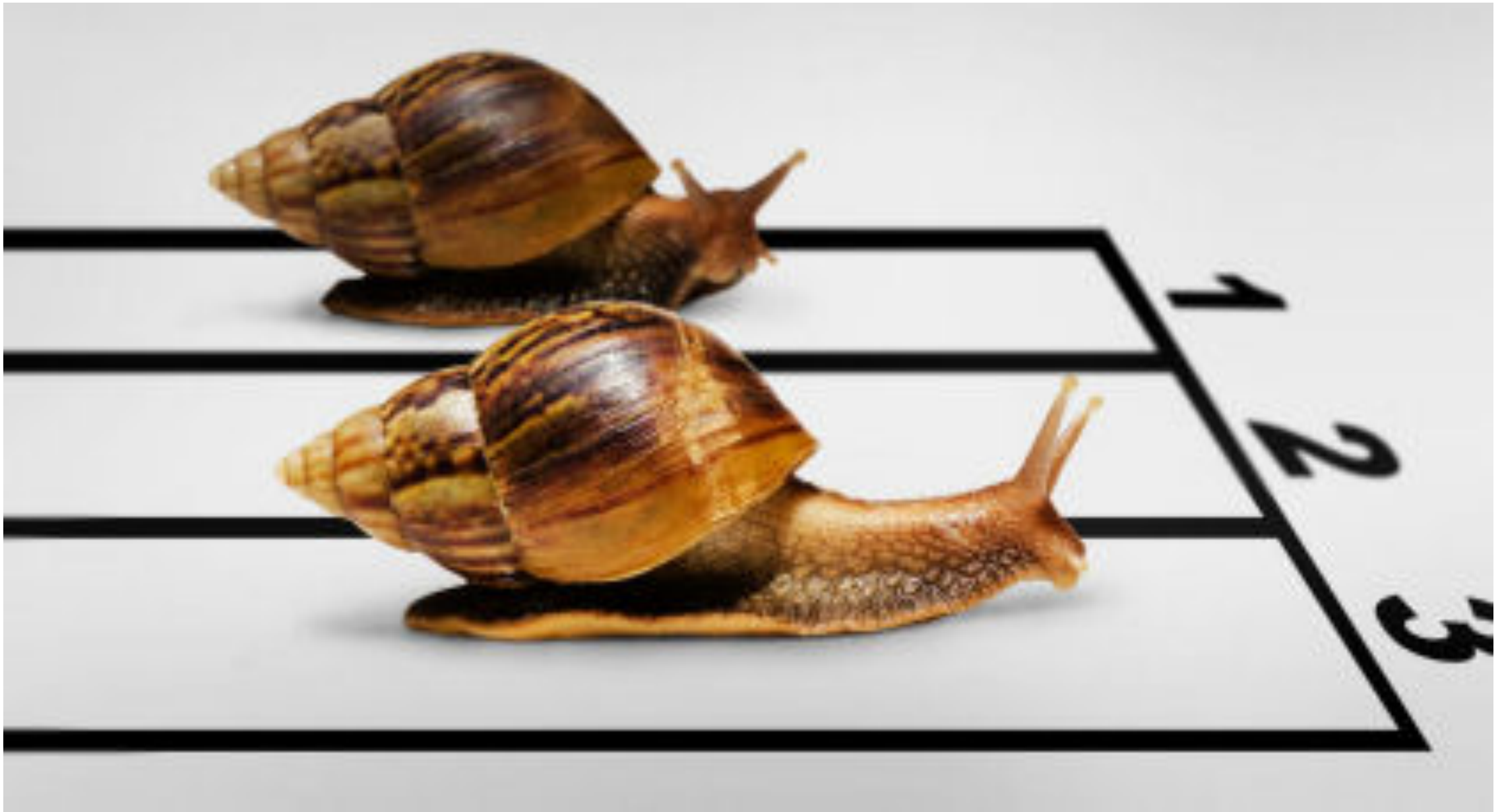

Speed things up! *Responsive Lighting*

Sensors Embedded
in lamps

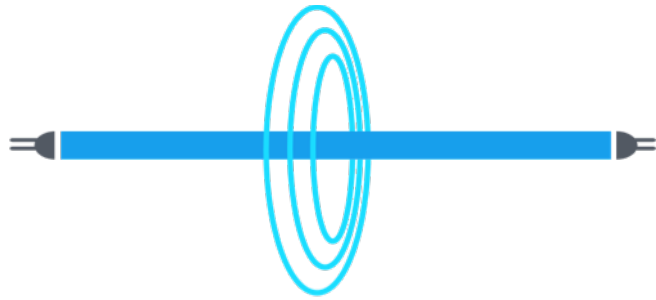

Wireless Controls and
Mesh Networks

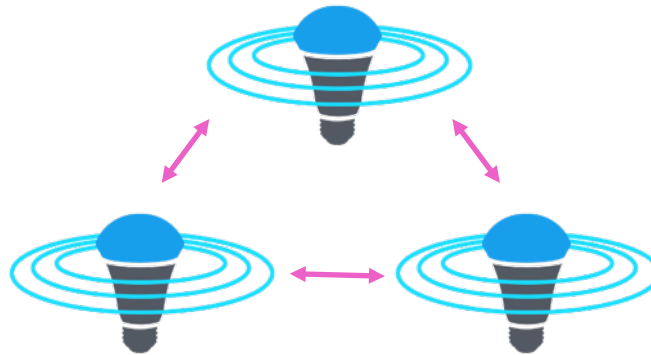

Simple
Commissioning of
Entire Zones

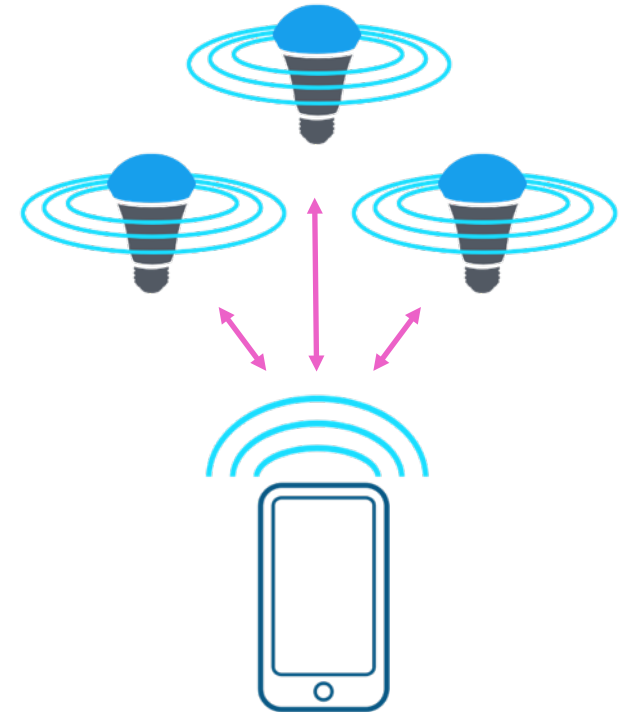

Manufacturers should have simple ways to embed sensors

Control Modules



Sensor Packages

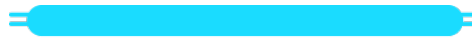
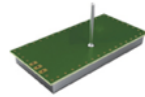
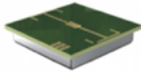
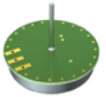

Directional

Linear



A19



Can Fixture



Troffer



Globe



PL



MR16
Fixtures



PAR38



4' & 2'
Tubes

Most common formats

Simple Installation: No Professionals Needed

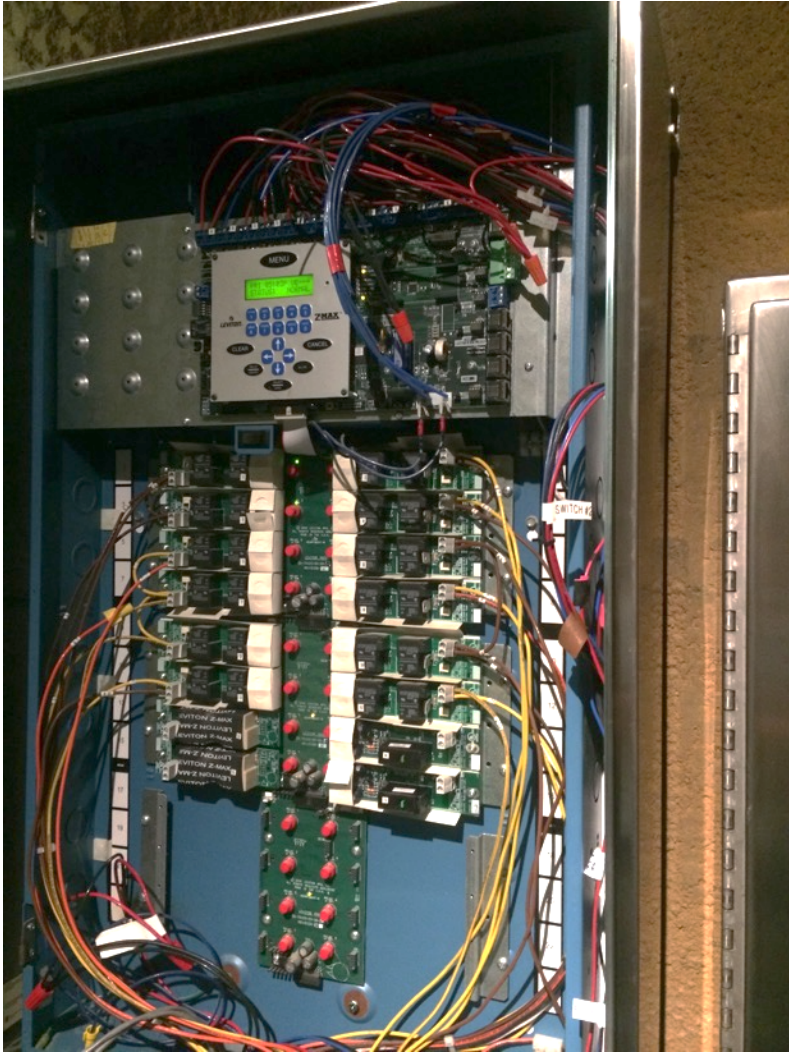

- Anyone can install
- Reduce upfront costs
- Solution for existing buildings



Before

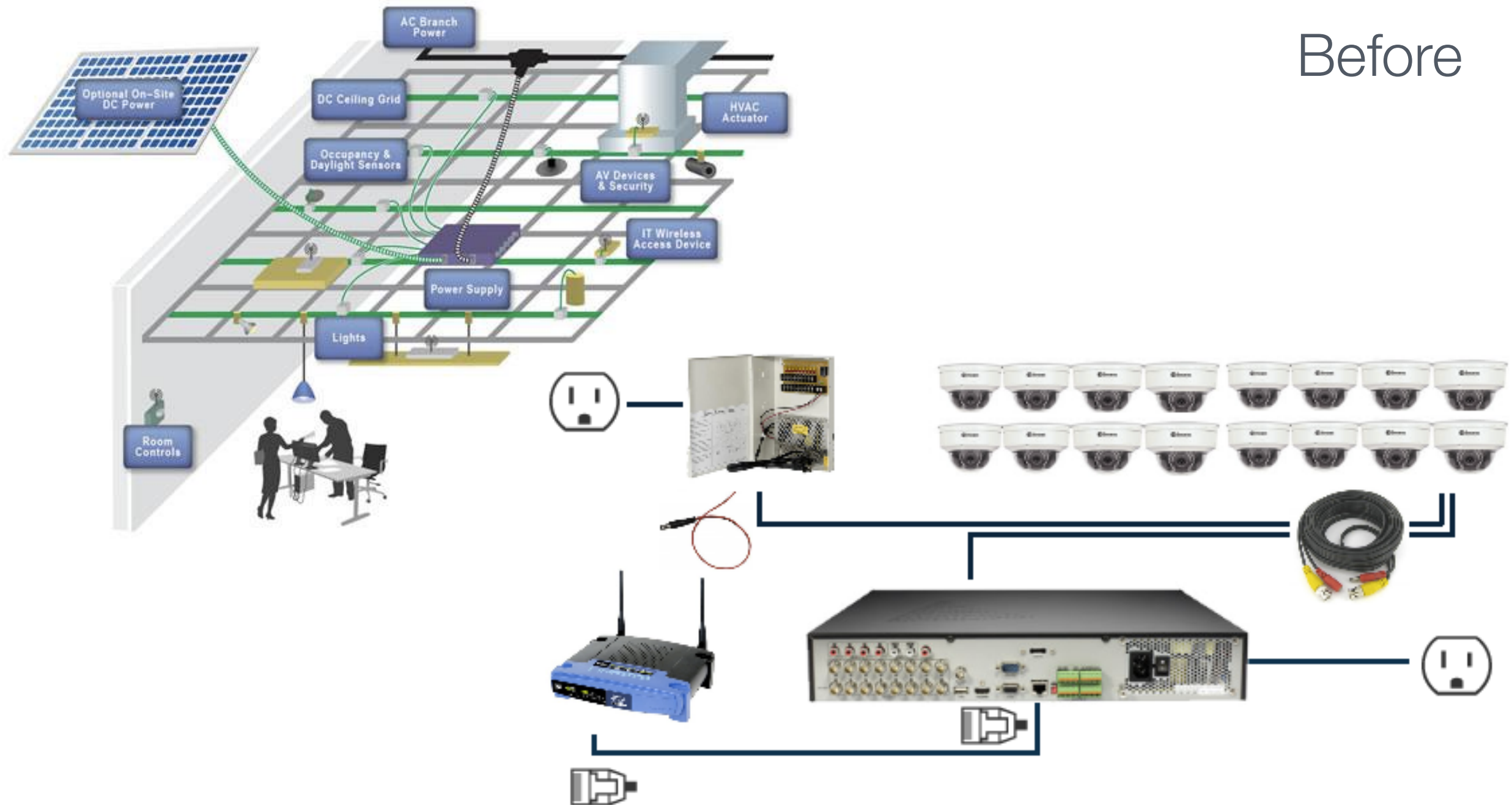

After



Massively reduced installation costs

Before
\$2.00-\$5.00

After
\$0.20-\$0.50

Per Square Foot

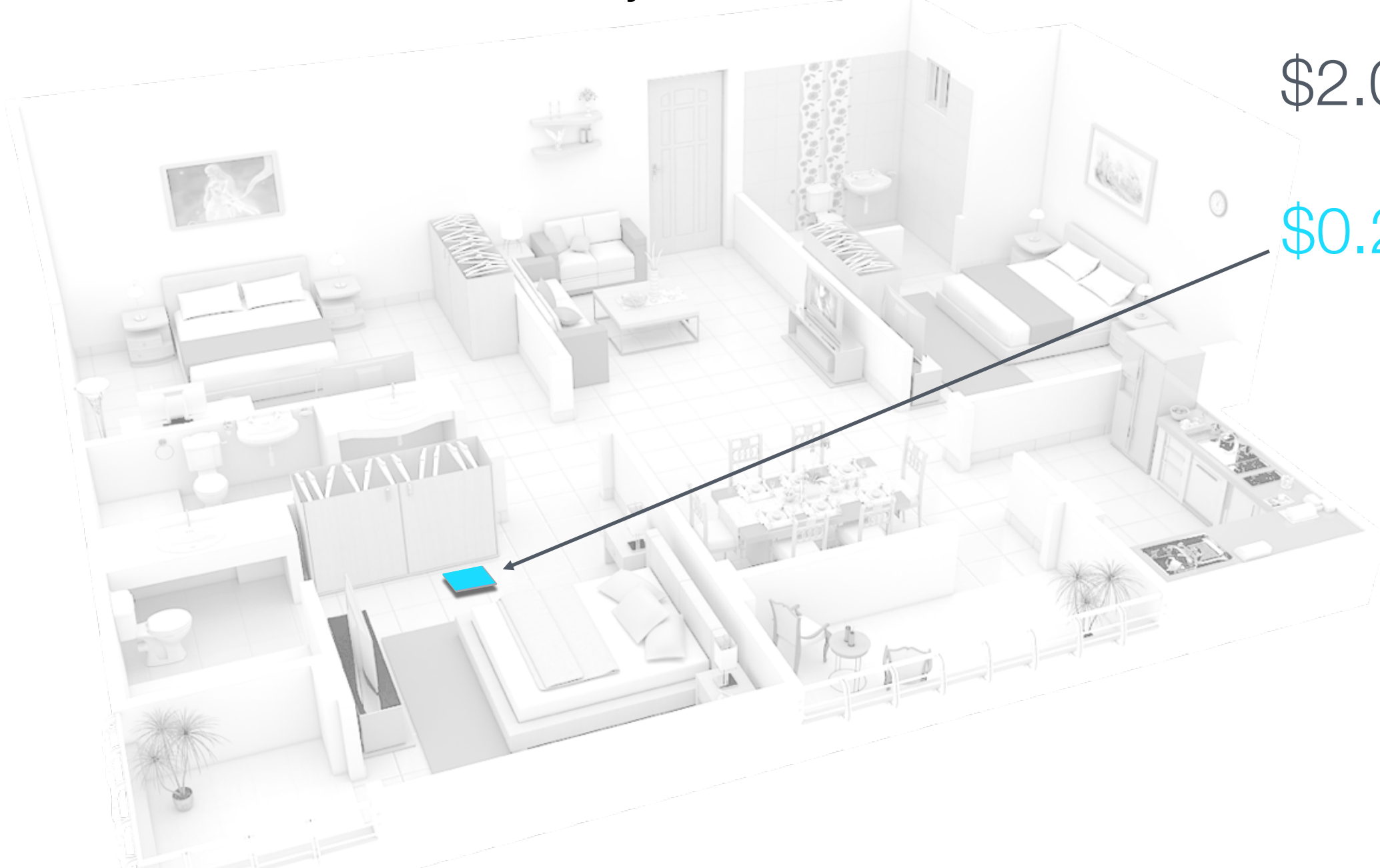

#1 – Leverage Existing Infrastructure!



Add Lights: Attic

[Skip](#)

- 1 Screw in the lights, leave them OFF
- 2 Press Start
- 3 Turn the lights ON
Lights that are turned ON will be added to this room.
- 4 When number of Lights Found shows all new lights, click 'Done'
Total Lights shows all lights currently assigned to this room.



Add Lights: Attic



Thanks

Please give us a moment to update your lights.

[Back](#)

Attic Lights



Tap a light below to watch it flash. Press and hold to remove it or change its room.

-  Connected lights in Attic
-  Selected and flashing light in Attic
-  Disconnected light (This light may be switched off, removed from the room, or too far from the hub)
-  Selected and flashing light in Attic



Utilize technologies to assist with commissioning

- Existing infrastructure
- Signal strength
- Visible Light Communication (VLC)
- Ultra-sonic
- Machine learning

Easily find and replace individual units

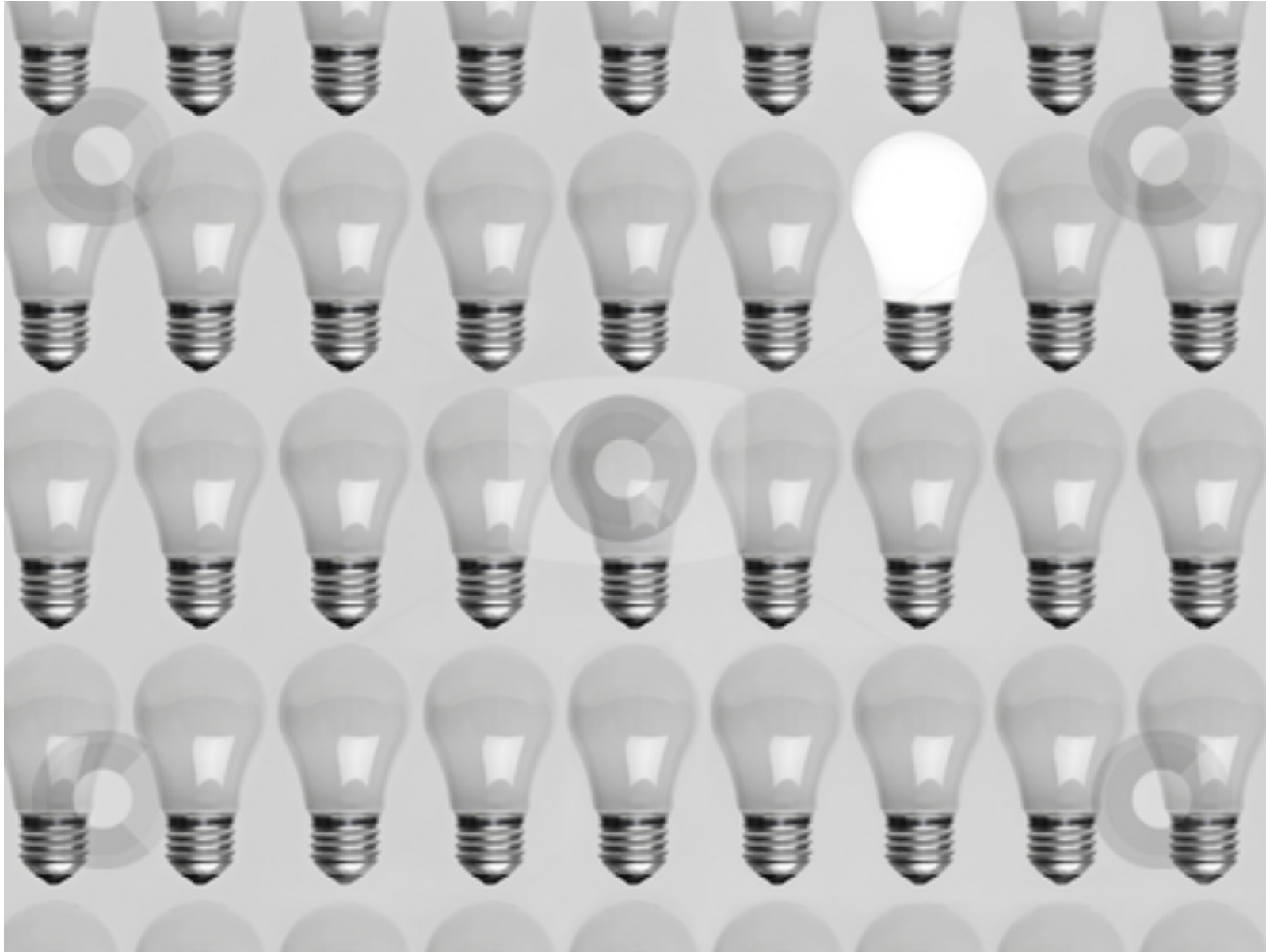

Save energy immediately!

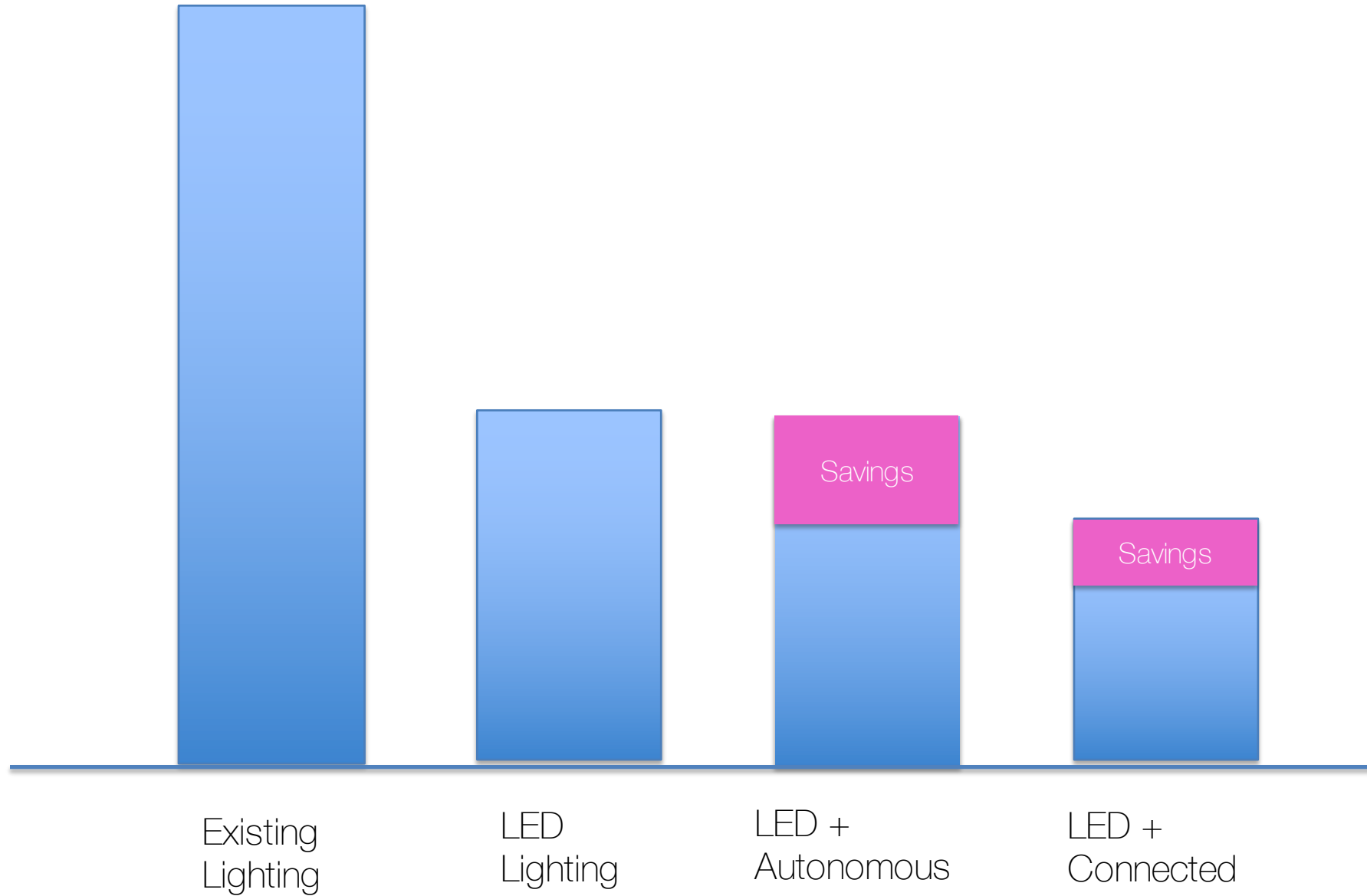

Allow multiple methods to control

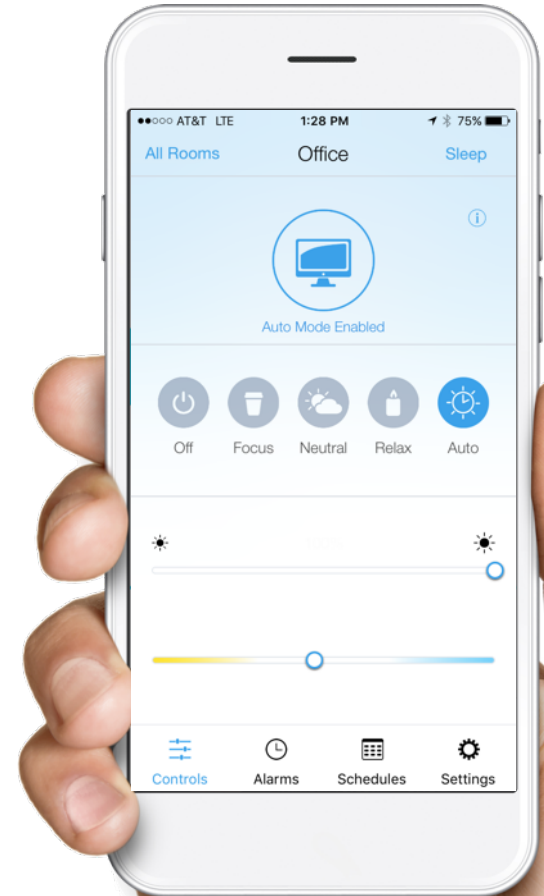

Settings, schedules, permissions

●●○○ AT&T LTE 1:28 PM 75%

All Rooms Office

Room Name Office

Type Office

Bulbs 10 Bulbs

Auto Mode >

Sleep Mode >

Occupancy Timeout ⓘ 20 mins

Ambient Light Sensing ⓘ ☒

Controls Alarms Schedules **Settings**

●●○○ AT&T LTE 1:27 PM 75%

All Rooms Office (+)

8:00 AM - 5:00 PM ☒
Schedule Every day

5:00 PM - 8:00 PM ☐
Schedule One time

Controls Alarms **Schedules** Settings

●●○○ AT&T LTE 1:27 PM 75%

Back User Management Close

Add User

bhamilton@stacklighting.com	Admin
katie@stacklighting.com	Admin
rich.manzana@gmail.com	Admin
jack@stacklighting.com	Admin
neilj2@gmail.com	Admin
brian@stacklighting.com	Admin
rich@stacklighting.com	Admin
cleader@stacklighting.com	User
Awu@stacklighting.com	Admin

Robust sensor platforms that integrate with other systems

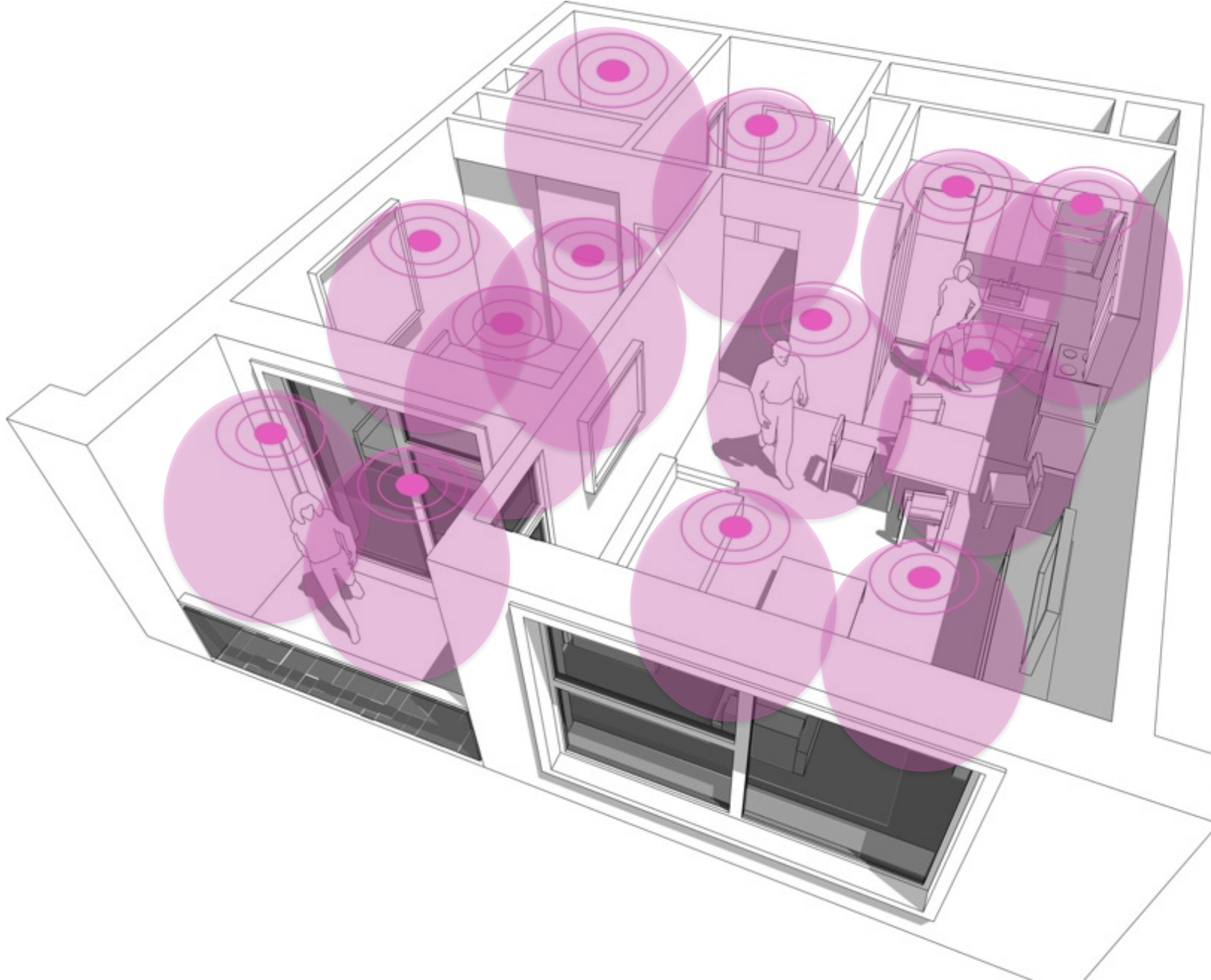

Open up solutions past controls



Building Controls



Health Care

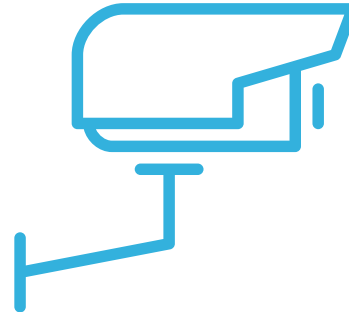

Security



Asset Tracking

Make it easy to generate useful information!

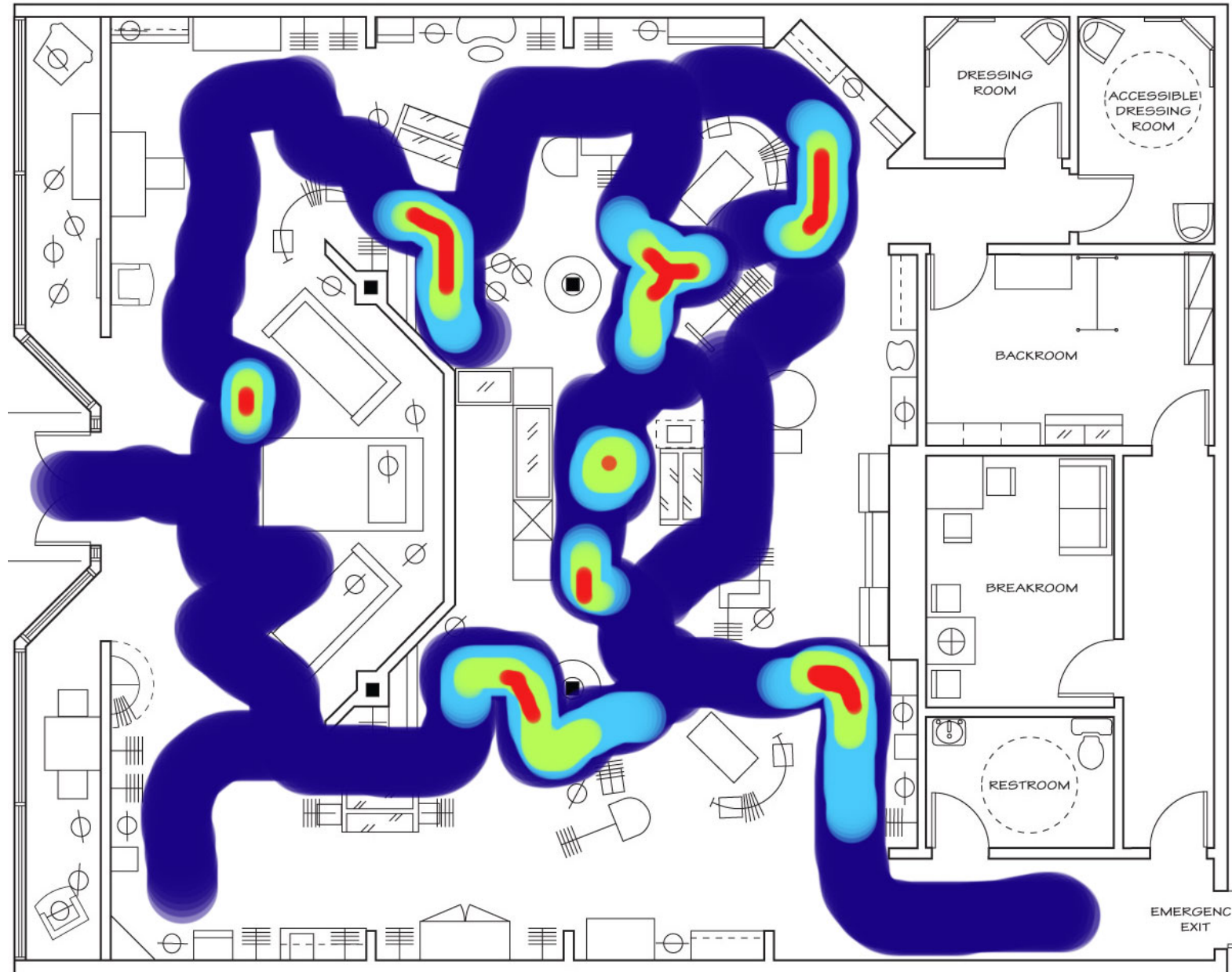



STACK

How to make spaces responsive