

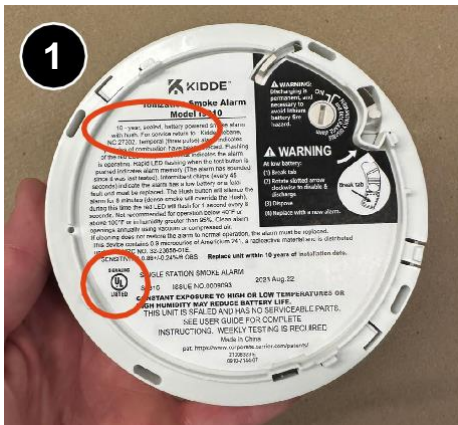

# Install Smoke Alarms

## Island Grantee Job Aid

Aligns With Standard Work Specification 2.0101.2



Select battery-operated smoke alarms that are listed and labeled in accordance with UL 217 and have sealed, non-replaceable, 10-year batteries. **2.0101.2a.**



Install smoke alarms in locations required by the Authority Having Jurisdiction (AHJ) (i.e. bedroom, hallway, living room, kitchen). **2.0101.2b.**

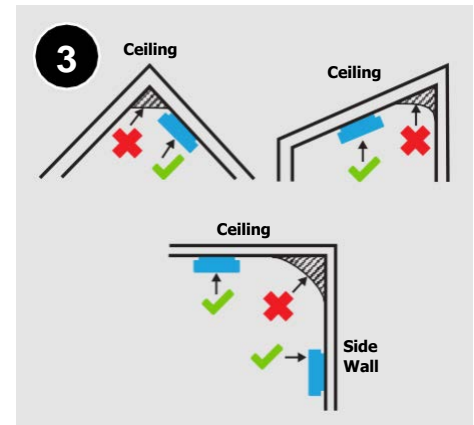

Avoid installing in locations with dead air space, or locations with excessive fresh air inlet (i.e., frequently used doors and windows).

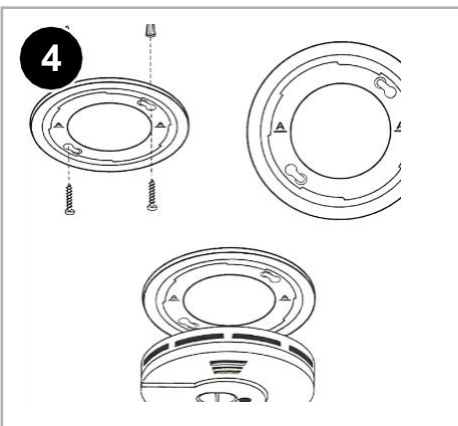

Install the smoke alarm in accordance with manufacturer instructions. **2.0101.2c.**



Provide occupants with the manufacturer written instructions. **2.0101.2d.**



## Checklist

# Install Smoke Alarms

## DESIRED OUTCOME

Properly selected and installed battery-operated smoke

- ☐ Verify UL 217 label.
- ☐ Verify appropriate location according to AHJ.

### ACKNOWLEDGEMENTS

Developed for the U.S. Department of Energy by Simonson Management Services (SMS) under contract #89243422FEE400259, with input from Weatherization trainers and providers throughout the country and the generous assistance of Catkins Solutions, Guam Energy Office, National Renewable Energy Laboratory, Richard Heath & Associates, and WxTV.

