

**DOE-ID NEPA CX DETERMINATION**  
**Idaho National Laboratory**

Page 1 of 5

CX Posting No.: DOE-ID-INL-23-014

<b>SECTION A. Project Title: SMC Sign Installation</b>
--

<b>SECTION B. Project Description and Purpose:</b>
--

Currently, there is no sign on Nile Avenue for the Specific Manufacturing Capability facility at the INL (see Figure 1 for proposed sign). This scope covered the ground preparation, creation, construction, and installation of the sign (See Figure 2 & 3 for approximate location). It also includes the required solar panels, battery box, conduit, and wiring to operate lights for night viewing (see Figure 4).

The sign will include the cast in polyester powder coating for maximum weather and fading protection, covered in stucco and design to match existing campus structures. The sign will have LED luminaries that will adjust and swivel, mounted to allow for tilt and direction.

The sign will also be designed and constructed to minimally impact wildlife and vegetation while also being protected from wildlife.

**DOE-ID NEPA CX DETERMINATION**  
**Idaho National Laboratory**

Page 2 of 5

CX Posting No.: DOE-ID-INL-23-014

**Figure 1: Sign from the Front**

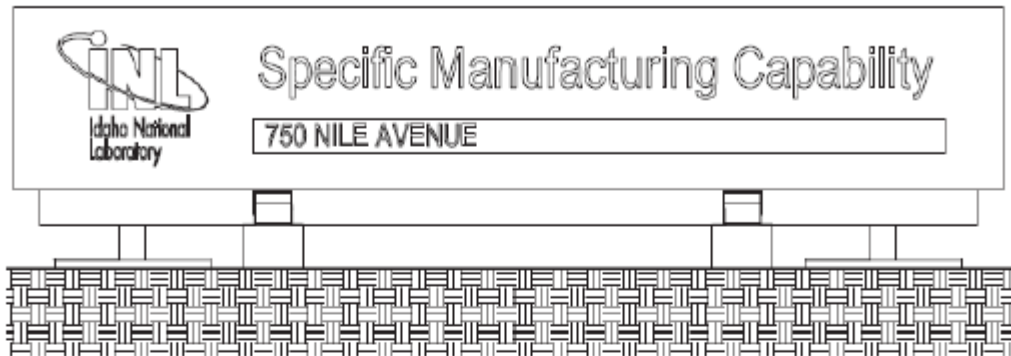

**Figure 2: Approximate Construction Location**

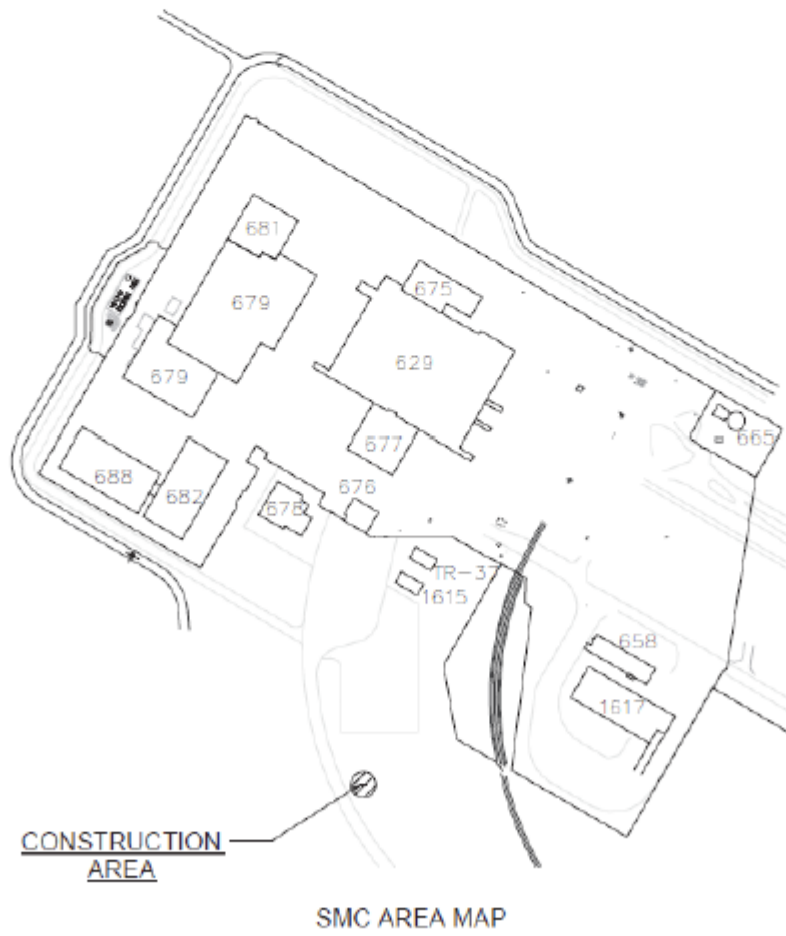

Figure 3: Enlarged Construction Area

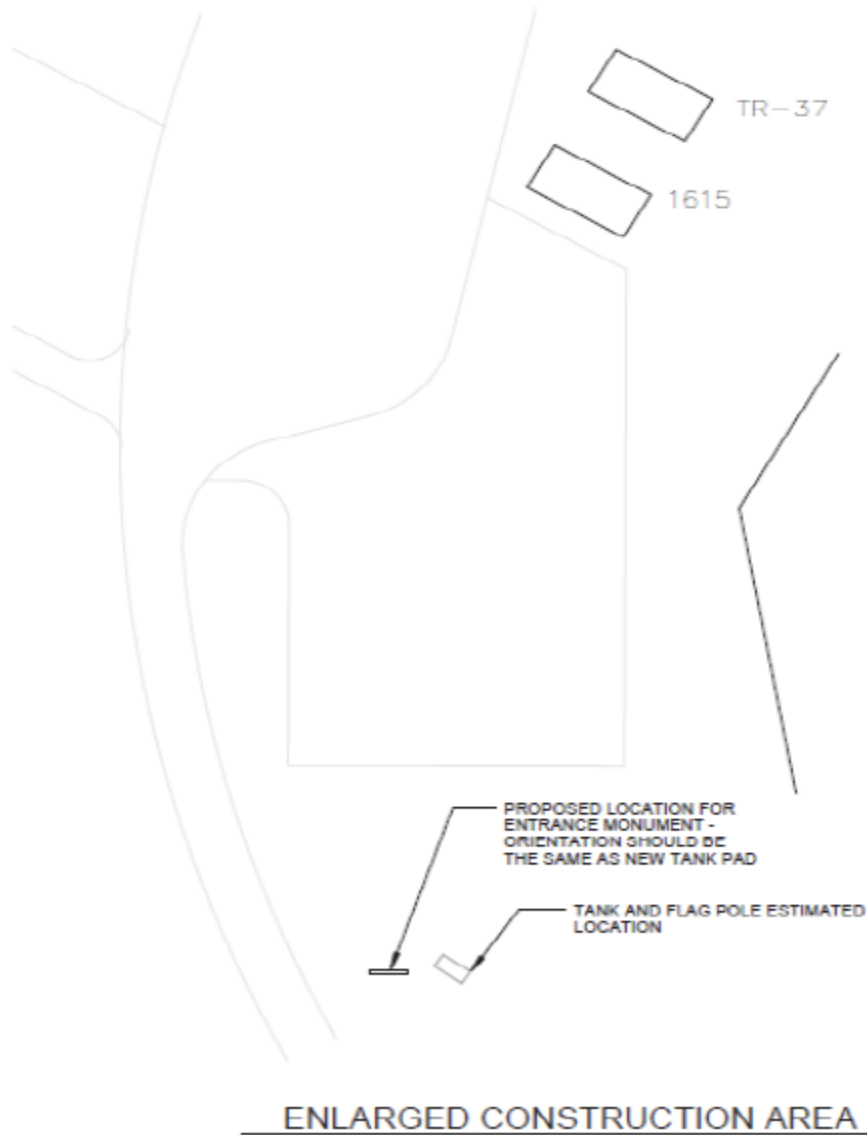
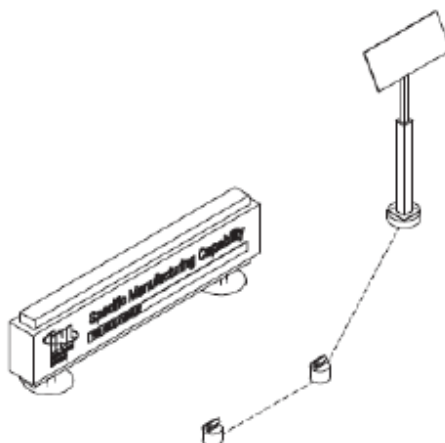

Figure 4: Finished Project



### SECTION C. Environmental Aspects or Potential Sources of Impact:

#### Air Emissions

Generating fugitive dust or other fugitive emissions. Emissions from combustion engines.

#### Discharging to Surface-, Storm-, or Ground Water

NA

#### Disturbing Cultural or Biological Resources

There is the potential for this work to impact vegetation and for project personnel to interact with various wildlife species. A Biological Resource Review will be arranged within two weeks prior to the initiation of any activities that might disturb soil or vegetation and again following completion of project activities. A nesting bird survey is included with the Biological Resource Review for actions occurring between April 1 - October 1 per compliance with the Migratory Bird Treaty Act. Bat surveys are also included with the Biological Resource Review in accordance with the INL Bat Protection Plan. Please refer to CRR BEA-23-05 for guidance on cultural resources.

#### Generating and Managing Waste

When wastes are generated, how they are disposed can adversely affect the environment. Managing wastes appropriately and responsibly and implementing recycling or reuse practices, where feasible, during project activities can reduce the potential impact on the environment.

#### Releasing Contaminants

When chemicals are used during the project there is the potential for spills that could impact the environment (air, water, soil).

#### Using, Reusing, and Conserving Natural Resources

Project description indicates materials will need to be purchased or used that require sourcing materials from the environment. Being conscientious about the types of materials used could reduce the impact to our natural resources.

**DOE-ID NEPA CX DETERMINATION**  
**Idaho National Laboratory**

Page 5 of 5

CX Posting No.: DOE-ID-INL-23-014

**SECTION D. Determine Recommended Level of Environmental Review, Identify Reference(s), and State Justification:** Identify the applicable categorical exclusion from 10 Code of Federal Regulation (CFR) 1021, Appendix B, give the appropriate justification, and the approval date.

For Categorical Exclusions (CXs), the proposed action must not: (1) threaten a violation of applicable statutory, regulatory, or permit requirements for environmental, safety, and health, or similar requirements of Department of Energy (DOE) or Executive Orders; (2) require siting and construction or major expansion of waste storage, disposal, recovery, or treatment or facilities; (3) disturb hazardous substances, pollutants, contaminants, or Comprehensive Environmental Response, Compensation, and Liability Act (CERCLA)-excluded petroleum and natural gas products that pre-exist in the environment such that there would be uncontrolled or unpermitted releases; (4) have the potential to cause significant impacts on environmentally sensitive resources (see 10 CFR 1021). In addition, no extraordinary circumstances related to the proposal exist that would affect the significance of the action. In addition, the action is not "connected" to other action actions (40 CFR 1508.25(a)(1)) and is not related to other actions with individually insignificant but cumulatively significant impacts (40 CFR 1608.27(b)(7)).

**References:**

B2.5 "Facility safety and environmental improvements"

**Justification:**

B2.5 Facility safety and environmental improvements. Safety and environmental improvements of a facility (including, but not limited to, replacement and upgrade of facility components) that do not result in a significant change in the expected useful life, design capacity, or function of the facility and during which operations may be suspended and then resumed. Improvements include, but are not limited to, replacement/upgrade of control valves, in-core monitoring devices, facility air filtration systems, or substation transformers or capacitors; addition of structural bracing to meet earthquake standards and/or sustain high wind loading; and replacement of aboveground or belowground tanks and related piping, provided that there is no evidence of leakage, based on testing in accordance with applicable requirements (such as 40 CFR part 265, "Interim Status Standards for Owners and Operators of Hazardous Waste Treatment, Storage, and Disposal Facilities" and 40 CFR part 280, "Technical Standards and Corrective Action Requirements for Owners and Operators of Underground Storage Tanks"). These actions do not include rebuilding or modifying substantial portions of a facility (such as replacing a reactor vessel).

Is the project funded by the American Recovery and Reinvestment Act of 2009 (Recovery Act) ☐ Yes ☒ No

Approved by Jason L. Anderson, DOE-ID NEPA Compliance Officer on: 4/10/2023