



U.S. Department of Energy

Categorical Exclusion Determination Form

Submit by E-mail

Proposed Action Title: Hassayampa Switching Station - Geologic Investigation

Program or Field Office: Western Area Power Administration/Desert Southwest Region

Location(s) (City/County/State): Hassayampa Switching Station, Buckeye, Arizona

Proposed Action Description:

Western Area Power Administration proposed to conduct geologic investigations at approximately 6 sites at the Hassayampa Switching Station, located near Buckeye, Arizona. Geologic information is required to complete the design and future construction. Geologic investigations would include: geologic mapping; subsurface investigation; earth resistivity testing; laboratory testing; and reporting.

Five of the bore holes will be with the existing property boundary and one bore hole will be in the existing transmission line right of way. The investigation consists of drilling bore holes, approximately 4 inches in diameter and 35 feet in depth, collecting soil or rock samples, and would backfill the holes with the removed materials. Workers will drive rubber-tired vehicles (truck-mounted auger or drill rig), a backhoe with an auger attachment, and a crew truck on existing access roads to reach bore hole locations. Road improvements are not required for this scope of work.

Special Conditions: (see attached)

Categorical Exclusion(s) Applied:

A9 - Information gathering, analysis, and dissemination

B3.1 - Site characterization and environmental monitoring

For the complete DOE National Environmental Policy Act regulations regarding categorical exclusions, including the full text of each categorical exclusion, see Subpart D of [10 CFR Part 1021](#).

Regulatory Requirements in 10 CFR 1021.410(b): (See full text in regulation)

☒ The proposal fits within a class of actions that is listed in Appendix A or B to 10 CFR Part 1021, Subpart D.

To fit within the classes of actions listed in 10 CFR Part 1021, Subpart D, Appendix B, a proposal must be one that would not: (1) threaten a violation of applicable statutory, regulatory, or permit requirements for environment, safety, and health, or similar requirements of DOE or Executive Orders; (2) require siting and construction or major expansion of waste storage, disposal, recovery, or treatment facilities (including incinerators), but the proposal may include categorically excluded waste storage, disposal, recovery, or treatment actions or facilities; (3) disturb hazardous substances, pollutants, contaminants, or CERCLA-excluded petroleum and natural gas products that preexist in the environment such that there would be uncontrolled or unpermitted releases; (4) have the potential to cause significant impacts on environmentally sensitive resources, including, but not limited to, those listed in paragraph B(4) of 10 CFR Part 1021, Subpart D, Appendix B; (5) involve genetically engineered organisms, synthetic biology, governmentally designated noxious weeds, or invasive species, unless the proposed activity would be contained or confined in a manner designed and operated to prevent unauthorized release into the environment and conducted in accordance with applicable requirements, such as those listed in paragraph B(5) of 10 CFR Part 1021, Subpart D, Appendix B.

☒ There are no extraordinary circumstances related to the proposal that may affect the significance of the environmental effects of the proposal.

☒ The proposal has not been segmented to meet the definition of a categorical exclusion. This proposal is not connected to other actions with potentially significant impacts (40 CFR 1508.25(a)(1)), is not related to other actions with individually insignificant but cumulatively significant impacts (40 CFR 1508.27(b)(7)), and is not precluded by 40 CFR 1506.1 or 10 CFR 1021.211 concerning limitations on actions during preparation of an environmental impact statement.

Based on my review of the proposed action, as NEPA Compliance Officer (as authorized under DOE Order 451.1B), I have determined that the proposed action fits within the specified class(es) of action, the other regulatory requirements set forth above are met, and the proposed action is hereby categorically excluded from further NEPA review.

NEPA Compliance Officer:

Amel Marant

Date Determined: 6/22/16

6-23-16

Special Considerations:

Cultural Considerations: On rare occasions, cultural or paleontological sites may be discovered during excavation or other earth-moving activities. Reporting: If archaeological material, paleontological material, or human remains are discovered, cease work in the area immediately and notify the Regional Preservation Officer at 602-605-2842. Stop all activities within a 100-foot-radius of the discovery, and do not proceed with work within that radius until approval by the Regional Preservation Officer. Care of Evidence: Protect the area. Do not remove, handle, alter, or damage artifacts or fossils uncovered during construction.

Biological Considerations: There is no effect to any species listed or critical habitat pursuant to the Endangered Species Act. Pursuant to the Migratory Bird Treaty Act, if there are any active nests (with young or eggs in it), contact Western's Biologist before approaching the nest for instruction on how to proceed.

END-----

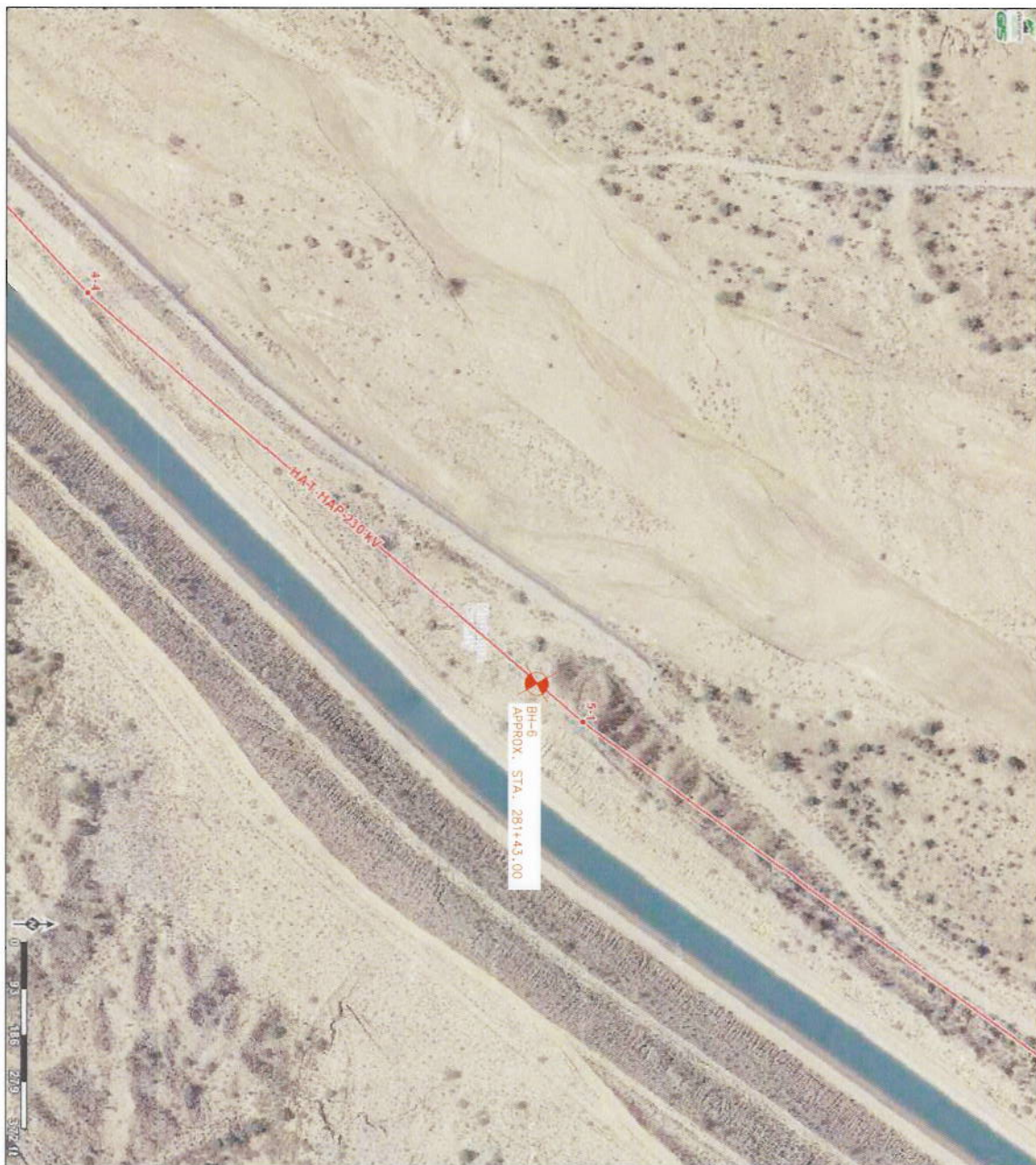

EXPLANATION
 --- PROPOSED BORING HOLE LOCATION

DESIGNED BY: DEFOR	APPROVED BY: [Signature]
DRAWN BY: [Signature]	CHECKED BY: [Signature]
DATE: March 16, 2016	PROJECT: HSS-SVN
DRAWING NO: 8000	
PROJECT NAME: WESTERN ARIZONA POWER AND LIGHT COMPANY HASSAYAMPA SWITCHING STATION-SUN VALLEY 230-KV TRANSMISSION LINE ARIZONA BORE HOLE PLAN	