

Plate 4

Organic chemicals detected
at SWMUs12-001(a), 12-001(b),
and 12-002 and AOC C-12-005

- Sample location
- SWMU or AOC
- Fence
- Dirt road
- - - Technical Area (TA) boundary

- Elevation contours
- 100-ft and 20-ft contour
 - 10-ft contour
 - 2-ft contour

Note: Concentrations are in mg/kg

FEATURE DATA REFERENCES

Hypsography: Los Alamos National Laboratory, ENV Environmental Remediation and Surveillance Program, 1991.

Point Feature Locations of the Environmental Restoration Project Database: Los Alamos National Laboratory, Waste and Environmental Services Division, EP2010-0035; 21 January 2010.

Potential Release Sites: Los Alamos National Laboratory, Waste and Environmental Services Division, Environmental Data and Analysis Group, EP2009-0633; 1:2,500 Scale Data; 25 January 2010.

Roads - Streets: County of Los Alamos, Information Services; as published 16 May 2006.

Road Pavement/Paved Road Arcs: Los Alamos National Laboratory, KSL Site Support Services, Planning, Locating and Mapping Section; 06 January 2004; as published 28 May 2009.

Paved Parking: Los Alamos National Laboratory, KSL Site Support Services, Planning, Locating and Mapping Section; 12 August 2002; as published 15 January 2009.

Dirt Road Arcs: Los Alamos National Laboratory, KSL Site Support Services, Planning, Locating and Mapping Section; 06 January 2004; as published 28 May 2009.

Security and Industrial Fences and Gates: Los Alamos National Laboratory, KSL Site Support Services, Planning, Locating and Mapping Section; 06 January 2004; as published 28 May 2009.

Storm Drain Line Distribution System: Los Alamos National Laboratory, KSL Site Support Services, Planning, Locating and Mapping Section; 06 January 2004; as published 28 May 2009.

Structures and Buildings - Structures: Los Alamos National Laboratory, KSL Site Support Services, Planning, Locating and Mapping Section; 06 January 2004; as published 28 May 2009.

Primary Landscape Features: Los Alamos National Laboratory, KSL Site Support Services, Planning, Locating and Mapping Section; 06 January 2004; as published 28 May 2009.

Former Structures of the Los Alamos Site: Los Alamos National Laboratory, Waste and Environmental Services Division, EP2008-0441; 1:2,500 Scale Data; 08 August 2008.

Technical Area Boundaries: Los Alamos National Laboratory, Site Planning & Project Initiation Group, Infrastructure Planning Office, September 2007; as published 04 December 2008.

Utilities - Communication Lines: Los Alamos National Laboratory, KSL Site Support Services, Planning, Locating and Mapping Section; 08 August 2002; as published 15 January 2009.

Primary Electric Grid: Los Alamos National Laboratory, KSL Site Support Services, Planning, Locating and Mapping Section; 06 January 2004; as published 28 May 2009.

Electric Utility Grid: County of Los Alamos, Information Services; as published 04 March 2009.

Primary Gas Distribution Lines: Los Alamos National Laboratory, KSL Site Support Services, Planning, Locating and Mapping Section; 06 January 2004; as published 28 May 2009.

Natural Gas Supply Distribution: County of Los Alamos, Information Services; as published 04 March 2009.

Point Features of the Sewer Line System: Los Alamos National Laboratory, KSL Site Support Services, Planning, Locating and Mapping Section; 06 January 2004; as published 28 May 2009.

Sewer Line System Maintained by the County of Los Alamos: County of Los Alamos, Information Services; as published 04 March 2009.

Steam Line Distribution System: Los Alamos National Laboratory, KSL Site Support Services, Planning, Locating and Mapping Section; 06 January 2004; as published 28 May 2009.

Water Lines: Los Alamos National Laboratory, KSL Site Support Services, Planning, Locating and Mapping Section; 06 January 2004; as published 28 May 2009.

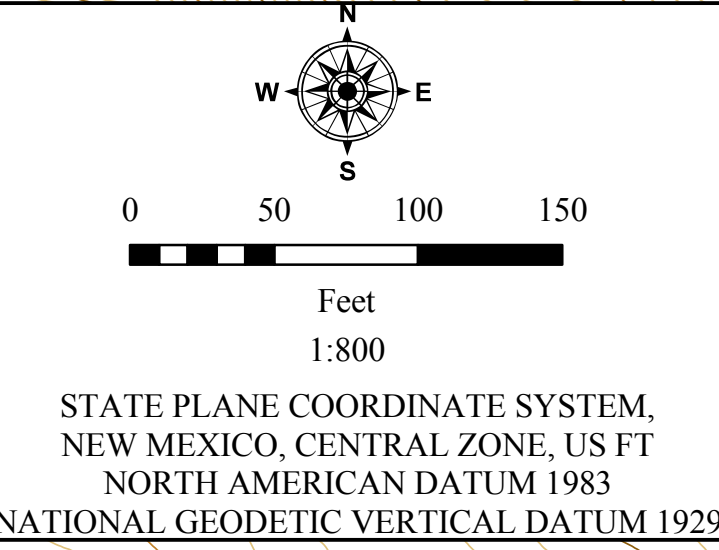

LOS ALAMOS NATIONAL LABORATORY
ENVIRONMENTAL PROGRAMS DIRECTORATE
CORRECTIVE ACTIONS PROJECTS
Los Alamos, New Mexico 87545

Map# 3MCA10-IR-01.3 ORG 01 APRIL 2010 LYON
Los Alamos Technical Associates (LATA-LAO)

This map was created for work processes associated with the Corrective Actions Projects (CAP) of the Los Alamos National Laboratory (LANL) Environmental Programs (EP) Directorate. All other uses for this map should be confirmed with LANL EP-CAP staff.